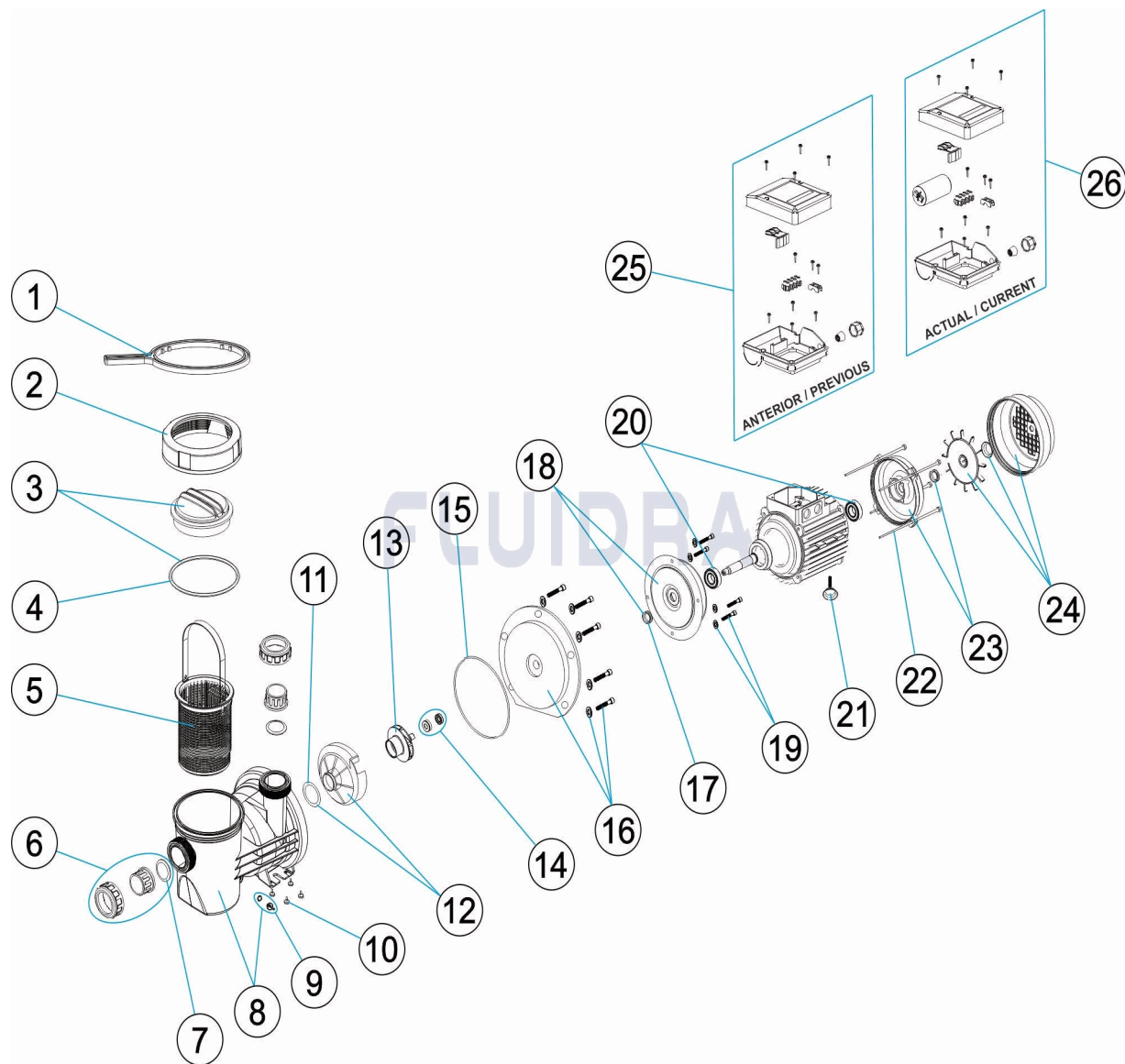

CODIGO **HGS101C-DS, HGS151C-DS**

 DESCRIPCION: **BOMBA HGS-DS**

ESPAÑOL

POS	CODIGO	DESCRIPCION	CANTIDAD	POS	CODIGO	DESCRIPCION	CANTIDAD
1	CE04130103	LLAVE TUERCA FILTRO		13	* CE05012017	RODETE 1 CV II	
2	CE05012401	TUERCA TAPA PREFILTRO NEGRA		13	* CE05012018	RODETE 1 1/2 CV II	
3	CE05012054	TAPA PREFILTRO CON JUNTA		14	CE05012028	JUNTA MECANICA	
4	CE05010178	JUNTA TORICA D. 151,7X6,99		15	CE05012029	JUNTA PLANA 193X5X11,5	
5	CE05012004	CESTO PREFILTRO		16	* CE05012030	BRIDA SOPORTE MOTOR C.71	
6	CE05012005	ACCESORIOS ENLACE D. 50		16	* CE05012031	BRIDA SOPORTE MOTOR C.80	
6	CE05012006	ACCESORIOS ENLACE D. 1 1/2"		17	* CE05010158	V-RINGS 0,5 HP - 1 HP	
6	CE05012007	ACCESORIOS ENLACE D. 63		17	* CE05010159	V-RINGS 1,5 HP - 3 HP	
6	CE05012008	ACCESORIOS ENLACE D. 2"		18	* CE05012032	BRIDA MECANICA C.71 C/CAJERA D35 NEG	
7	CE05010773	JUNTA TORICA MANGUITO		18	* CE05012033	BRIDA MECANICA C.80 C/CAJERA D47 NEG	
8	CE05012055	CUERPO BOMBA		19	* CE05012035	TORNILLOS FIJACION BRIDA C.71	
9	CE04121107	TAPON 1/4 VALVULA		19	* CE05012036	TORNILLOS FIJACION BRIDA C.80	
10	CE05012012	TOPE GOMA HGS-HPS		20	* CE05010135	RODAMIENTO MOTOR < 1 HP	

* NOTA OBSERVACIONES

CODIGO **HGS101C-DS, HGS151C-DS**DESCRIPCION: **BOMBA HGS-DS**

11	CE05012013	JUNTA TORICA 47,63X3,54	20	* CE05012038	RODAMIENTO DEL 2-3 CV 6204 ZRS
12	CE05012014	DIFUSOR	21	* CE05012040	PIE MOTOR M6X53 C.71
21	* CE05012041	PIE MOTOR M6X45 C.80	24	* CE05010148	CJTO. VENTILADOR-TAPA 1,5 - 2 - 3 HP III
22	* CE05010144	VARILLAS MOTOR 0,75 - 1 HP	25	* CE05012047	CJTO. CAJA BORNES (MOTOR II) C.71
22	* CE05010145	VARILLAS MOTOR 1,5 - 3 HP III	25	* CE05012048	CJTO. CAJA BORNES (MOTOR II) C.80
23	* CE05012043	TAPA MOTOR MEC. C.71 C/CAJERA D35	26	* CE05010890	CONJ. CONDENSADOR 12/20 MF
23	* CE05012044	TAPA MOTOR MEC. C.80 C/CAJERA D47	26	* CE05010891	CONJ. CONDENSADOR 16/25 MF
24	* CE05010147	CJTO. VENTILADOR-TAPA 0,75 - 1 HP			

CODIGO **HGS101C-DS, HGS151C-DS**DESCRIPCION: **BOMBA HGS-DS****OBSERVACIONES**

POS	CODIGO	OBSERVACIONES
13	*CE05012017	PARA: HGS101C-DS
13	*CE05012018	PARA: HGS151C-DS
16	*CE05012030	PARA: HGS101C-DS
16	*CE05012031	PARA: HGS151C-DS
17	*CE05010158	PARA: HGS101C-DS
17	*CE05010159	PARA: HGS151C-DS
18	*CE05012032	PARA: HGS101C-DS
18	*CE05012033	PARA: HGS151C-DS
19	*CE05012035	PARA: HGS101C-DS
19	*CE05012036	PARA: HGS151C-DS
20	*CE05010135	PARA: HGS101C-DS
20	*CE05012038	PARA: HGS151C-DS
21	*CE05012040	PARA: HGS101C-DS
21	*CE05012041	PARA: HGS151C-DS
22	*CE05010144	PARA: HGS101C-DS
22	*CE05010145	PARA: HGS151C-DS
23	*CE05012043	PARA: HGS101C-DS
23	*CE05012044	PARA: HGS151C-DS
24	*CE05010147	PARA: HGS101C-DS
24	*CE05010148	PARA: HGS151C-DS
25	*CE05012047	PARA: HGS101C-DS
25	*CE05012048	PARA: HGS151C-DS
26	*CE05010890	PARA: HGS101C-DS
26	*CE05010891	PARA: HGS151C-DS

CODE HGS101C-DS, HGS151C-DS

DESCRIPTION: POMPE HGS-DS

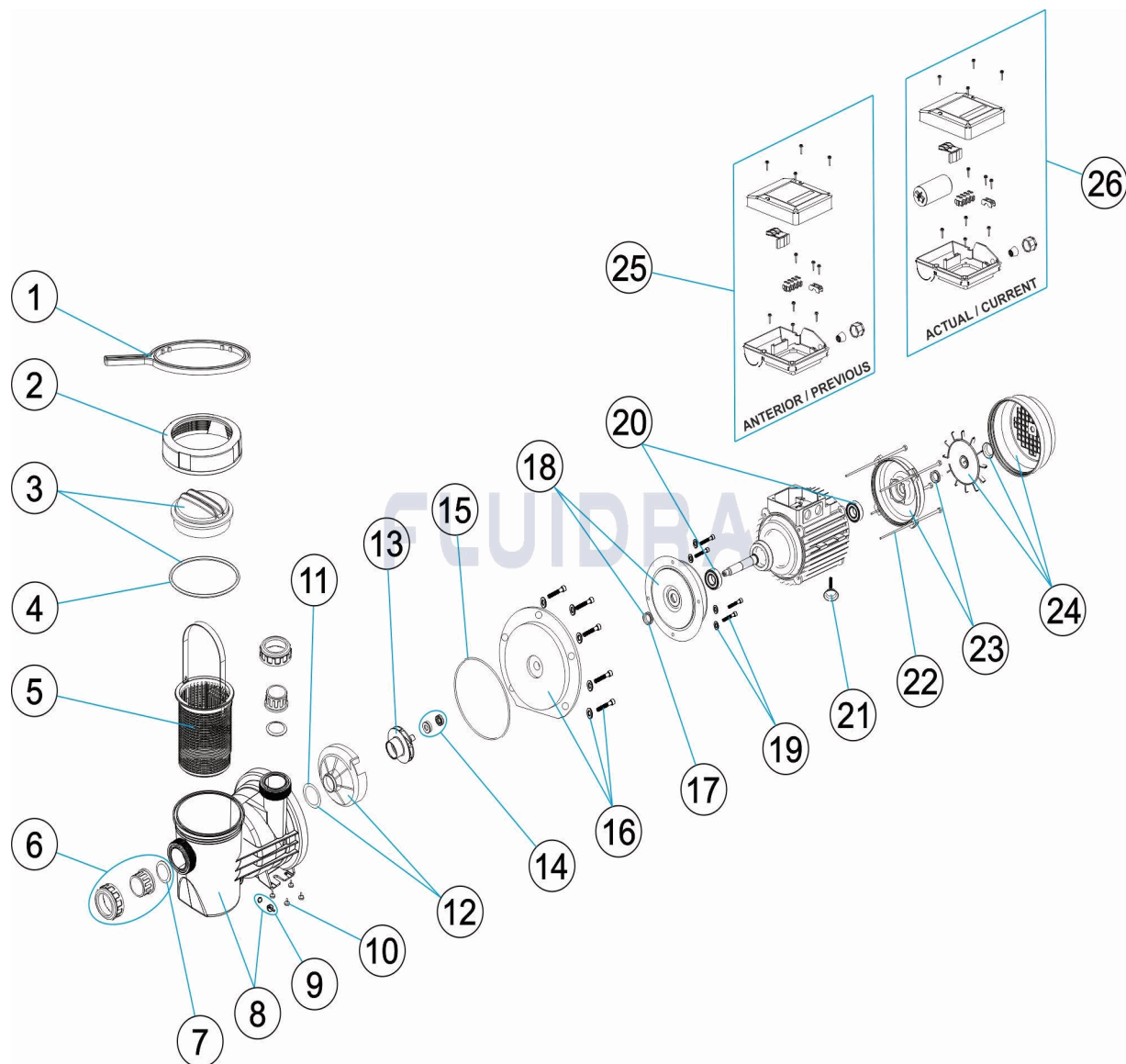
FRANCAIS

POS	CODE	DESCRIPTION	QUANTITE	POS	CODE	DESCRIPTION	QUANTITE
1	CE04130103	CLE ECROU DE FILTRE		13	* CE05012017	TURBINE 1 CV II	
2	CE05012401	ECROU COUVERCLE PRÉFILTRE		13	* CE05012018	TURBINE 1 1/2 CV II	
3	CE05012054	COUVERCLE PREFILTRE AVEC JOINT		14	CE05012028	GARNITURE MÉCANIQUE	
4	CE05010178	JOINT TORIQUE D 151,7X6,99		15	CE05012029	JOINT PLAT 193X5X11,5	
5	CE05012004	PANIER PRÉFILTRE		16	* CE05012030	BRIDE SUPPORT MOTEUR C.71	
6	CE05012005	RACCORDS UNION D 50		16	* CE05012031	BRIDE SUPPORT MOTEUR C.80	
6	CE05012006	RACCORDS UNION D 1 1/2"		17	* CE05010158	V-RINGS 0,5 HP - 1 HP	
6	CE05012007	RACCORDS UNION D 63		17	* CE05010159	V-RINGS 1,5 HP - 3 HP	
6	CE05012008	RACCORDS UNION D 2"		18	* CE05012032	BRIDE MEC C.71 AVEC EMBOITEMENT D.36	
7	CE05010773	JOINT TORIQUE MANCHON		18	* CE05012033	BRIDE MEC C.80 AVEC EMBOITEMENT D.47	
8	CE05012055	CORPS POMPE		19	* CE05012035	VIS FIXATION BRIDE C.71	
9	CE04121107	BOUCHON 1/4' DE VANNE		19	* CE05012036	VIS FIXATION BRIDE C.80	
10	CE05012012	SILENT-BLOCK		20	* CE05010135	ROULEMENT MOTEUR < 1 HP	

* VOIR FICHE D'OBSERVATIONS

CODE **HGS101C-DS, HGS151C-DS**

DESCRIPTION: **POMPE HGS-DS**

11	CE05012013	JOINT TORIQUE 47,63X3,54	20	* CE05012038	ROULEMENT AVANT & ARRIÈRE
12	CE05012014	DIFFUSEUR	21	* CE05012040	PIED MOTEUR M6X53 C.71
21	* CE05012041	PIED MOTEUR M6X45 C.80	24	* CE05010148	ENSEMBLE COUVERCLE VENTILATEUR 1,5
22	* CE05010144	TIRANTS D'ACCOUPLMENT MOTEUR 0,7!	25	* CE05012047	ENSEMBLE CAISSON BORNES (MOTEUR II
22	* CE05010145	TIRANTS D'ACCOUPLMENT MOTEUR 1,5	25	* CE05012048	ENSEMBLE CAISSON BORNES (MOTEUR II
23	* CE05012043	COUVERCLE MOTEUR MEC. C.71 ET RAIN	26	* CE05010890	ENS. CONDENSATEUR 12/20 MF
23	* CE05012044	COUVERCLE MOTEUR MEC. C.80 ET RAIN	26	* CE05010891	ENS. CONDENSATEUR 16/25 MF
24	* CE05010147	ENSEMBLE COUVERCLE VENTILATEUR 0,			

CODE **HGS101C-DS, HGS151C-DS**

DESCRIPTION: **POMPE HGS-DS**

OBSERVATIONS

POS	CODE	OBSERVATIONS
13	*CE05012017	POUR: HGS101C-DS
13	*CE05012018	POUR: HGS151C-DS
16	*CE05012030	POUR: HGS101C-DS
16	*CE05012031	POUR: HGS151C-DS
17	*CE05010158	POUR: HGS101C-DS
17	*CE05010159	POUR: HGS151C-DS
18	*CE05012032	POUR: HGS101C-DS
18	*CE05012033	POUR: HGS151C-DS
19	*CE05012035	POUR: HGS101C-DS
19	*CE05012036	POUR: HGS151C-DS
20	*CE05010135	POUR: HGS101C-DS
20	*CE05012038	POUR: HGS151C-DS
21	*CE05012040	POUR: HGS101C-DS
21	*CE05012041	POUR: HGS151C-DS
22	*CE05010144	POUR: HGS101C-DS
22	*CE05010145	POUR: HGS151C-DS
23	*CE05012043	POUR: HGS101C-DS
23	*CE05012044	POUR: HGS151C-DS
24	*CE05010147	POUR: HGS101C-DS
24	*CE05010148	POUR: HGS151C-DS
25	*CE05012047	POUR: HGS101C-DS
25	*CE05012048	POUR: HGS151C-DS
26	*CE05010890	POUR: HGS101C-DS
26	*CE05010891	POUR: HGS151C-DS

CODE HGS101C-DS, HGS151C-DS

DESCRIPTION: HGS-DS PUMP

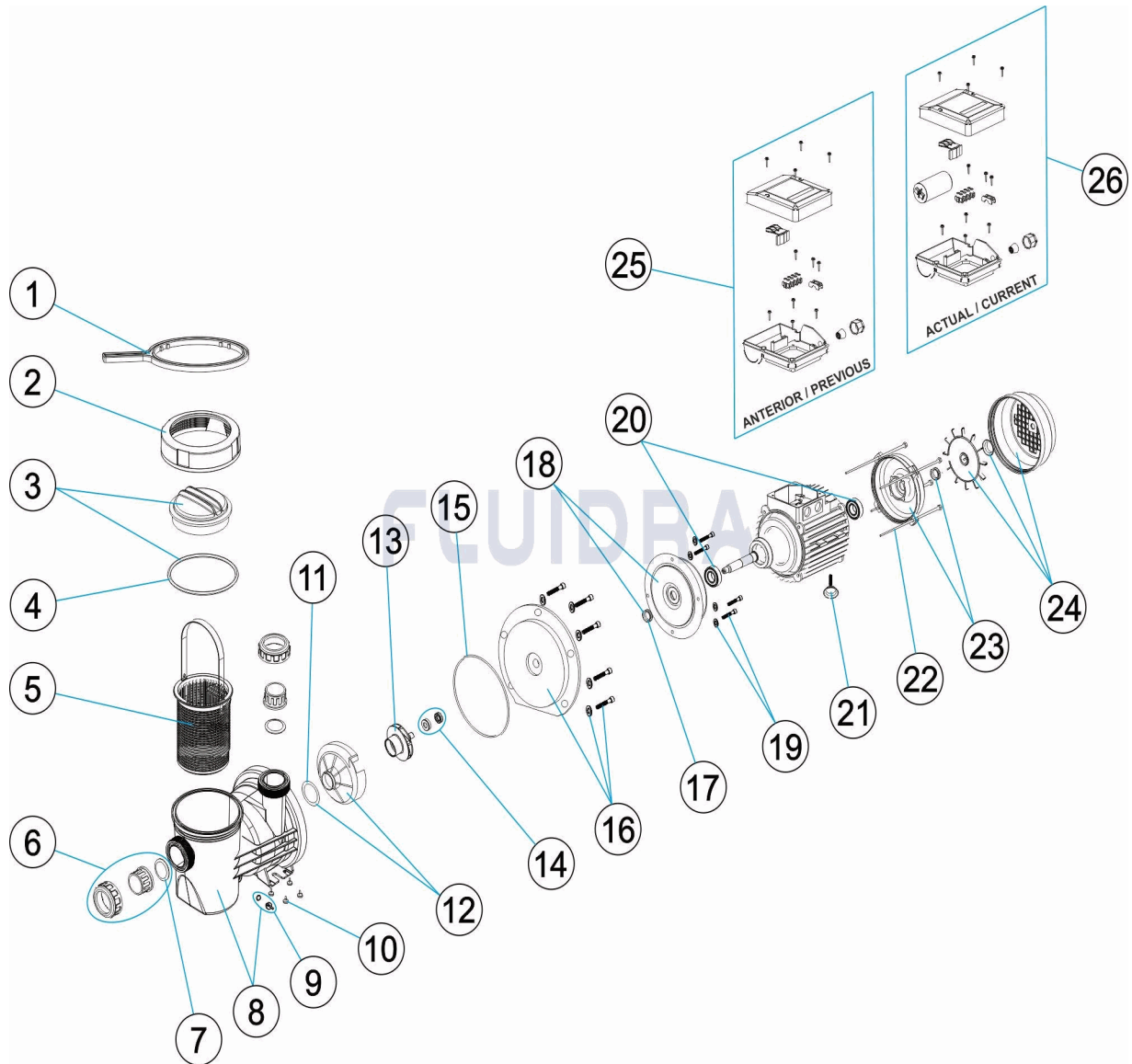
ENGLISH

POS	CODE	DESCRIPTION	QUANTITY	POS	CODE	DESCRIPTION	QUANTITY
1	CE04130103	LID SPANNER		13	* CE05012017	IMPELLER 1 CV II	
2	CE05012401	PRE-FILTER COVER NUT		13	* CE05012018	IMPELLER 1 1/2 CV II	
3	CE05012054	PRE-FILTER COVER WITH GASKET		14	CE05012028	MECHANICAL SEAL	
4	CE05010178	O' RING D 151,7X6,99		15	CE05012029	FLAT GASKET 193X5X11,5	
5	CE05012004	PRE-FILTER BASKET		16	* CE05012030	MOTOR BRIDLE C.71	
6	CE05012005	UNION FITTINGS D 50		16	* CE05012031	MOTOR BRIDLE C.80	
6	CE05012006	UNION FITTINGS D 1 1/2"		17	* CE05010158	V-RINGS 0,5 HP - 1 HP	
6	CE05012007	UNION FITTINGS D 63		17	* CE05010159	V-RINGS 1,5 HP - 3 HP	
6	CE05012008	UNION FITTINGS D 2"		18	* CE05012032	MEC. MOTOR BRIDLE C.71	
7	CE05010773	SOCKET O'RING		18	* CE05012033	MEC. MOTOR BRIDLE C.80	
8	CE05012055	PUMP HOUSING		19	* CE05012035	SCREWS FIXING DIVING BRIDLE C.71	
9	CE04121107	PLUG 1/4'		19	* CE05012036	SCREWS FIXING DIVING BRIDLE C.80	
10	CE05012012	SILENBLOCK		20	* CE05010135	MOTOR BEARINGS < 1 HP	

CODE **HGS101C-DS, HGS151C-DS**

DESCRIPTION: **HGS-DS PUMP**

11	CE05012013	O' RING 47,63X3,54	20	* CE05012038	FRONT & REAR BEARING
12	CE05012014	DIFFUSER	21	* CE05012040	STAND BASE M6X53 C.71
21	* CE05012041	STAND BASE M6X45 C.71	24	* CE05010148	FAN COVER ASSEMBLY 1,5 - 2 - 3 HP III
22	* CE05010144	MOTOR TIES 0,75 - 1 HP	25	* CE05012047	TERMINAL BOX ASSEMBLY (MOTOR II) C.71
22	* CE05010145	MOTOR TIES 1,5 - 3 HP III	25	* CE05012048	TERMINAL BOX ASSEMBLY (MOTOR II) C.8C
23	* CE05012043	MEC. MOTOR COVER C.71	26	* CE05010890	CONDENSER 12/20 MF KIT
23	* CE05012044	MEC. MOTOR COVER C.80	26	* CE05010891	CONDENSER 16/25 MF KIT
24	* CE05010147	FAN COVER ASSEMBLY 0,75 - 1 HP			

CODE **HGS101C-DS, HGS151C-DS**

DESCRIPTION: **HGS-DS PUMP**

OBSERVATIONS

POS	CODE	OBSERVATIONS
13	*CE05012017	FOR: HGS101C-DS
13	*CE05012018	FOR: HGS151C-DS
16	*CE05012030	FOR: HGS101C-DS
16	*CE05012031	FOR: HGS151C-DS
17	*CE05010158	FOR: HGS101C-DS
17	*CE05010159	FOR: HGS151C-DS
18	*CE05012032	FOR: HGS101C-DS
18	*CE05012033	FOR: HGS151C-DS
19	*CE05012035	FOR: HGS101C-DS
19	*CE05012036	FOR: HGS151C-DS
20	*CE05010135	FOR: HGS101C-DS
20	*CE05012038	FOR: HGS151C-DS
21	*CE05012040	FOR: HGS101C-DS
21	*CE05012041	FOR: HGS151C-DS
22	*CE05010144	FOR: HGS101C-DS
22	*CE05010145	FOR: HGS151C-DS
23	*CE05012043	FOR: HGS101C-DS
23	*CE05012044	FOR: HGS151C-DS
24	*CE05010147	FOR: HGS101C-DS
24	*CE05010148	FOR: HGS151C-DS
25	*CE05012047	FOR: HGS101C-DS
25	*CE05012048	FOR: HGS151C-DS
26	*CE05010890	FOR: HGS101C-DS
26	*CE05010891	FOR: HGS151C-DS

CODICE HGS101C-DS, HGS151C-DS

DESCRIZIONE: POMPA HGS-DS

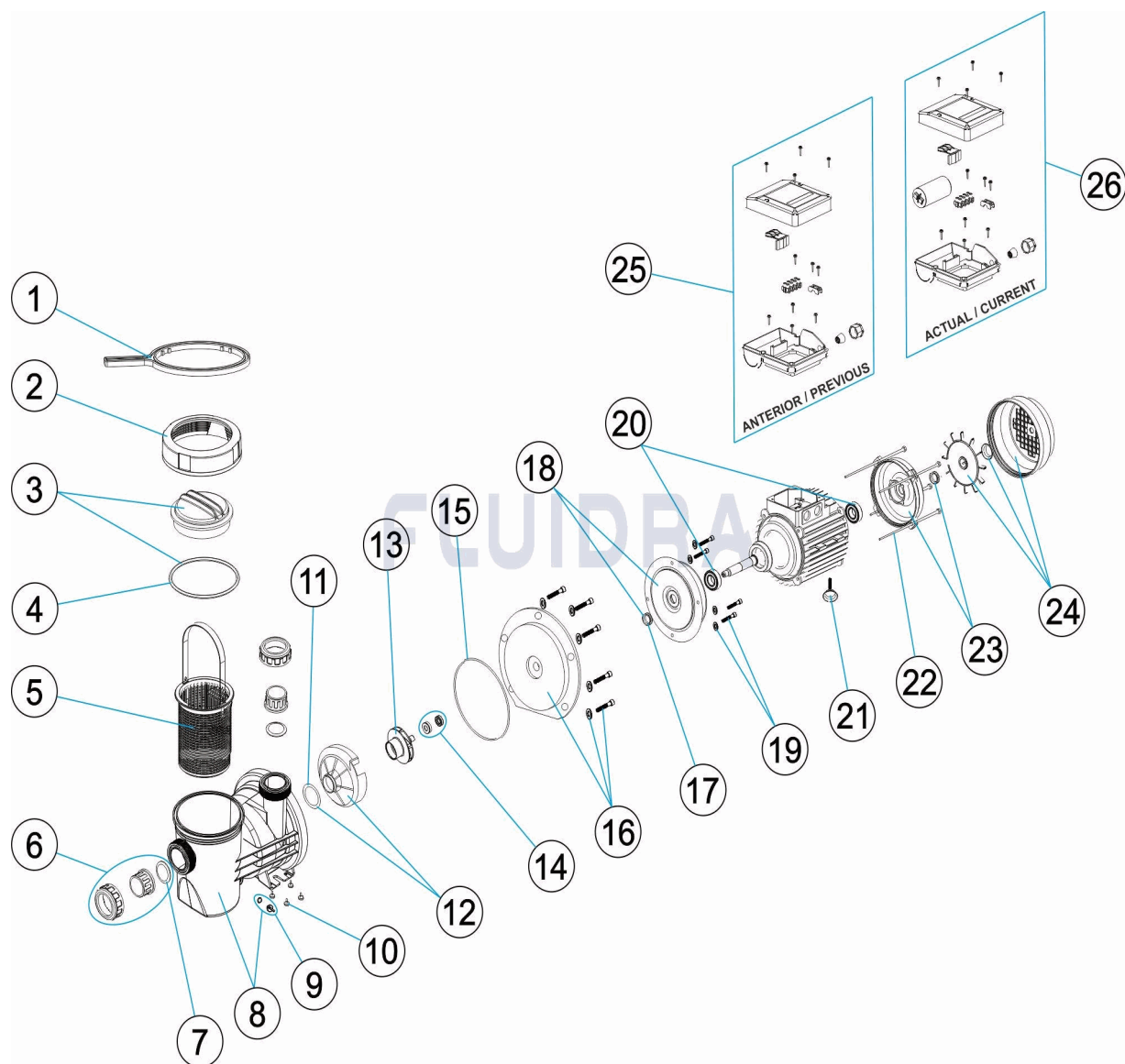
ITALIANO

POS	CODICE	DESCRIZIONE	QUANTITA'	POS	CODICE	DESCRIZIONE	QUANTITA'
1	CE04130103	CHIAVE GHIERA PER FILTRO		13	* CE05012017	RUOTA 1 CV II	
2	CE05012401	VITE COPERCHIO PREFILTRO		13	* CE05012018	RUOTA 1 1/2 CV II	
3	CE05012054	COPERCHIO PREFILTRO CON GUARNIZIO		14	CE05012028	TENUTA MECCANICA	
4	CE05010178	O-RING D 151,7X6,99		15	CE05012029	GUARNIZIONE PIANA 193X5X11,5	
5	CE05012004	CESTO PREFILTRO		16	* CE05012030	FLANGIA SUPPORTO MOTORE C.71	
6	CE05012005	MANICOTTI DI UNIONE D 50		16	* CE05012031	FLANGIA SUPPORTO MOTORE C.80	
6	CE05012006	MANICOTTI DI UNIONE D 1 1/2"		17	* CE05010158	V-RINGS 0,5 HP - 1 HP	
6	CE05012007	MANICOTTI DI UNIONE D 63		17	* CE05010159	V-RINGS 1,5 HP - 3 HP	
6	CE05012008	MANICOTTI DI UNIONE D 2"		18	* CE05012032	TENUTA MECCANICA C.71 CASSA D. 35	
7	CE05010773	O-RING MANICOTTO		18	* CE05012033	TENUTA MECCANICA C.80 CASSA D. 47	
8	CE05012055	CORPO POMBA		19	* CE05012035	VITI FISSAGGIO FLANGIA C.71	
9	CE04121107	COPERCHIO 1/4' VALVOLA		19	* CE05012036	VITI FISSAGGIO FLANGIA C.80	
10	CE05012012	SILENTBLOC		20	* CE05010135	CUSCINETTO MOTORE < 1 HP	

* SI FACCIÀ RIFERIMENTO AL FOGLIO DELLE OSSERVAZIONI

CODICE **HGS101C-DS, HGS151C-DS**

DESCRIZIONE: **POMPA HGS-DS**

11	CE05012013	O-RING 47,63X3,54	20	* CE05012038	CUSCINETTO ANTERIORE & POSTERIORE
12	CE05012014	DIFFUSORE	21	* CE05012040	PIEDE MOTORE M6X53 C.71
21	* CE05012041	PIEDE MOTORE M6X45 C.80	24	* CE05010148	KIT VENTOLA-COPRIVENTOLA 1,5 - 2 - 3 HF
22	* CE05010144	ASTAS MOTORE 0,75 - 1 HP	25	* CE05012047	SET CASSETTA TERMINALI (MOTORE II) C.:
22	* CE05010145	ASTAS MOTORE 1,5 - 3 HP III	25	* CE05012048	SET CASSETTA TERMINALI (MOTORE II) C.:
23	* CE05012043	COPERCHIO MOTORE MEC. C.71 C/CASSII	26	* CE05010890	CONGIUNTO CONDENSATORE 12/20 MF
23	* CE05012044	COPERCHIO MOTORE MEC. C.80 C/CASSII	26	* CE05010891	CONGIUNTO CONDENSATORE 16/25 MF
24	* CE05010147	KIT VENTOLA-COPRIVENTOLA 0,75 - 1 HP			

CODICE **HGS101C-DS, HGS151C-DS**DESCRIZIONE: **POMPA HGS-DS**

OSSERVAZIONI

POS	CODICE	OSSERVAZIONI
13	*CE05012017	PER: HGS101C-DS
13	*CE05012018	PER: HGS151C-DS
16	*CE05012030	PER: HGS101C-DS
16	*CE05012031	PER: HGS151C-DS
17	*CE05010158	PER: HGS101C-DS
17	*CE05010159	PER: HGS151C-DS
18	*CE05012032	PER: HGS101C-DS
18	*CE05012033	PER: HGS151C-DS
19	*CE05012035	PER: HGS101C-DS
19	*CE05012036	PER: HGS151C-DS
20	*CE05010135	PER: HGS101C-DS
20	*CE05012038	PER: HGS151C-DS
21	*CE05012040	PER: HGS101C-DS
21	*CE05012041	PER: HGS151C-DS
22	*CE05010144	PER: HGS101C-DS
22	*CE05010145	PER: HGS151C-DS
23	*CE05012043	PER: HGS101C-DS
23	*CE05012044	PER: HGS151C-DS
24	*CE05010147	PER: HGS101C-DS
24	*CE05010148	PER: HGS151C-DS
25	*CE05012047	PER: HGS101C-DS
25	*CE05012048	PER: HGS151C-DS
26	*CE05010890	PER: HGS101C-DS
26	*CE05010891	PER: HGS151C-DS

CODE HGS101C-DS, HGS151C-DS

BESCHREIBUNG: PUMPE HGS-DS

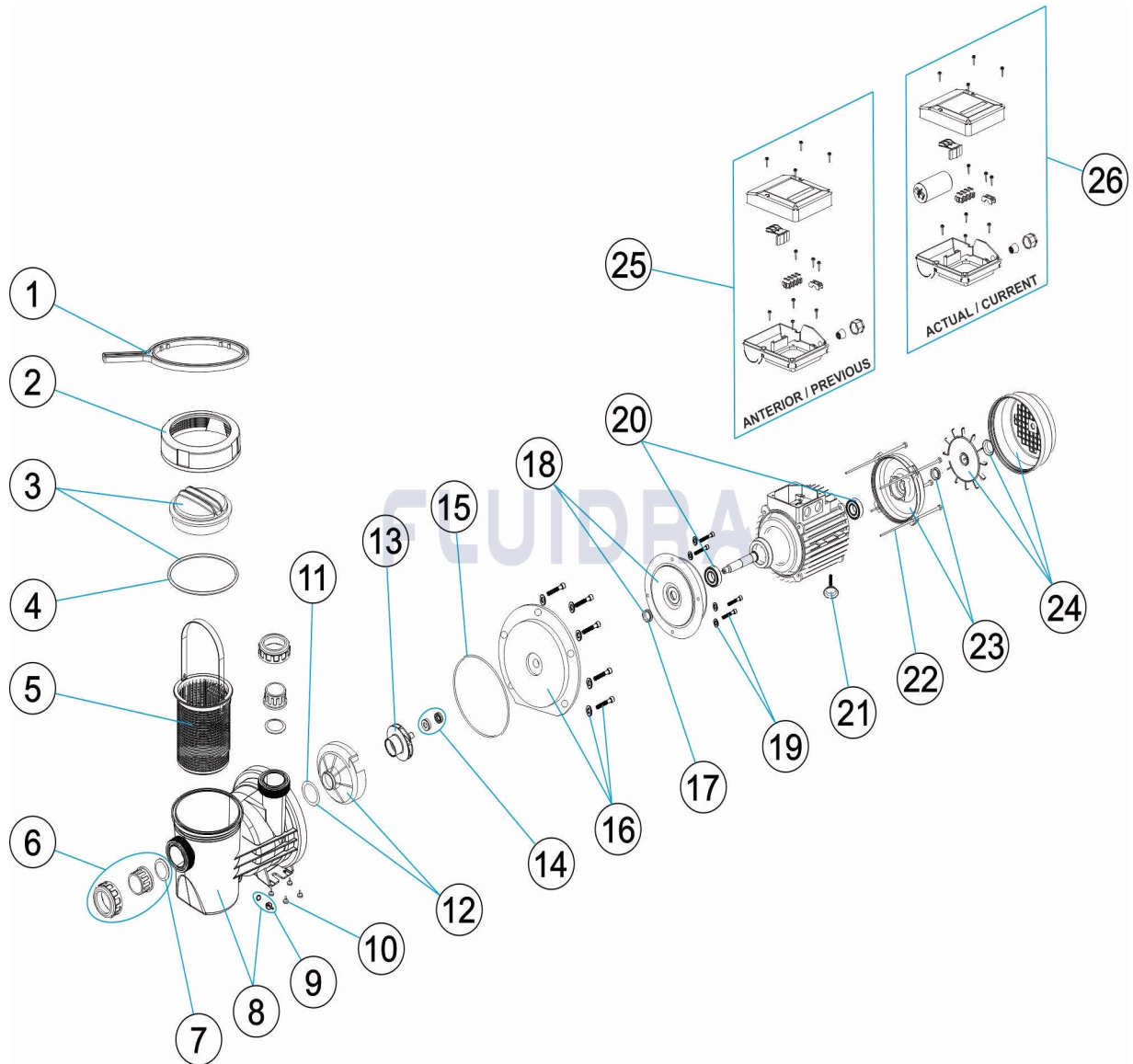

DEUTSCH

POS	CODE	BESCHREIBUNG	MENGE	POS	CODE	BESCHREIBUNG	MENGE
1	CE04130103	SCHLÜSSEL MUTTER FILTER		13	* CE05012017	LAUFRAD 1 CV II	
2	CE05012401	MUTTER VORFILTERDECKEL SCHWARZ		13	* CE05012018	LAUFRAD 1 1/2 CV II	
3	CE05012054	VORFILTERABDECKUNG UND DICHTUNG		14	CE05012028	GLEITRINGDICHTUNG	
4	CE05010178	O-RING D. 151,7 X 6,99		15	CE05012029	FLACHDICHTUNG 193 X 5 X 11,5	
5	CE05012004	VORFILTERKORB		16	* CE05012030	FLANSCH MOTORHALTERUNG C.71	
6	CE05012005	ANSCHLUSSZUBEHÖR D. 50		16	* CE05012031	FLANSCH MOTORHALTERUNG C.80	
6	CE05012006	ANSCHLUSSZUBEHÖR D. 1 1/2"		17	* CE05010158	DICHTUNGSRINGE 0,5 HP - 1 HP	
6	CE05012007	ANSCHLUSSZUBEHÖR D. 63		17	* CE05010159	DICHTUNGSRINGE 1,5 HP - 3 HP	
6	CE05012008	ANSCHLUSSZUBEHÖR D. 2"		18	* CE05012032	GLEITRINGDICHTUNG C.71 MIT RINGLAGE	
7	CE05010773	O-RING NIPPEL		18	* CE05012033	GLEITRINGDICHTUNG C.80 MIT RINGLAGE	
8	CE05012055	PUMPENGEHÄUSE		19	* CE05012035	FIXIERSCHRAUBEN FLANSCH C.71	
9	CE04121107	STOPFEN 1/4" VENTIL		19	* CE05012036	FIXIERSCHRAUBEN FLANSCH C.80	
10	CE05012012	ABSCHLUSS GUMMI HGS - PSS		20	* CE05010135	WÄLZLAGER MOTOR < 1 HP	

* SIEHE ANMERKUNGSBLATT

CODE **HGS101C-DS, HGS151C-DS**

BESCHREIBUNG: **PUMPE HGS-DS**

11	CE05012013	O-RING 47,63 X 3,54	20	* CE05012038	VORDERES WÄLZLAGER 2 - 3 CV 6204 ZRS
12	CE05012014	WASSERVERTEILER	21	* CE05012040	FUSS MOTOR M6 X 53 C.71
21	* CE05012041	FUSS MOTOR M6 X 45 C.80	24	* CE05010148	SET VENTILATOR - ABDECKUNG 1,5 - 2 - 3 I
22	* CE05010144	RUNDEISEN MOTOR 0,75 - 1 HP	25	* CE05012047	SET KLEMMSCHRANK (MOTOR II) C.71
22	* CE05010145	RUNDEISEN MOTOR 1,5 - 3 HP III	25	* CE05012048	SET KLEMMSCHRANK (MOTOR II) C.80
23	* CE05012043	MOTORDECKEL MECH. C.71 MIT RINGLAG	26	* CE05010890	SET KONDENSATOR 12/20 MF
23	* CE05012044	MOTORDECKEL MECH. C.80 MIT RINGLAG	26	* CE05010891	SET KONDENSATOR 16/25 MF
24	* CE05010147	SET VENTILATOR - ABDECKUNG 0,75 - 1 H			

CODE **HGS101C-DS, HGS151C-DS**

BESCHREIBUNG: **PUMPE HGS-DS**

HINWEISE

POS	CODE	HINWEISE
13	*CE05012017	FÜR: HGS101C-DS
13	*CE05012018	FÜR: HGS151C-DS
16	*CE05012030	FÜR: HGS101C-DS
16	*CE05012031	FÜR: HGS151C-DS
17	*CE05010158	FÜR: HGS101C-DS
17	*CE05010159	FÜR: HGS151C-DS
18	*CE05012032	FÜR: HGS101C-DS
18	*CE05012033	FÜR: HGS151C-DS
19	*CE05012035	FÜR: HGS101C-DS
19	*CE05012036	FÜR: HGS151C-DS
20	*CE05010135	FÜR: HGS101C-DS
20	*CE05012038	FÜR: HGS151C-DS
21	*CE05012040	FÜR: HGS101C-DS
21	*CE05012041	FÜR: HGS151C-DS
22	*CE05010144	FÜR: HGS101C-DS
22	*CE05010145	FÜR: HGS151C-DS
23	*CE05012043	FÜR: HGS101C-DS
23	*CE05012044	FÜR: HGS151C-DS
24	*CE05010147	FÜR: HGS101C-DS
24	*CE05010148	FÜR: HGS151C-DS
25	*CE05012047	FÜR: HGS101C-DS
25	*CE05012048	FÜR: HGS151C-DS
26	*CE05010890	FÜR: HGS101C-DS
26	*CE05010891	FÜR: HGS151C-DS

CODIGO **HGS101C-DS, HGS151C-DS**

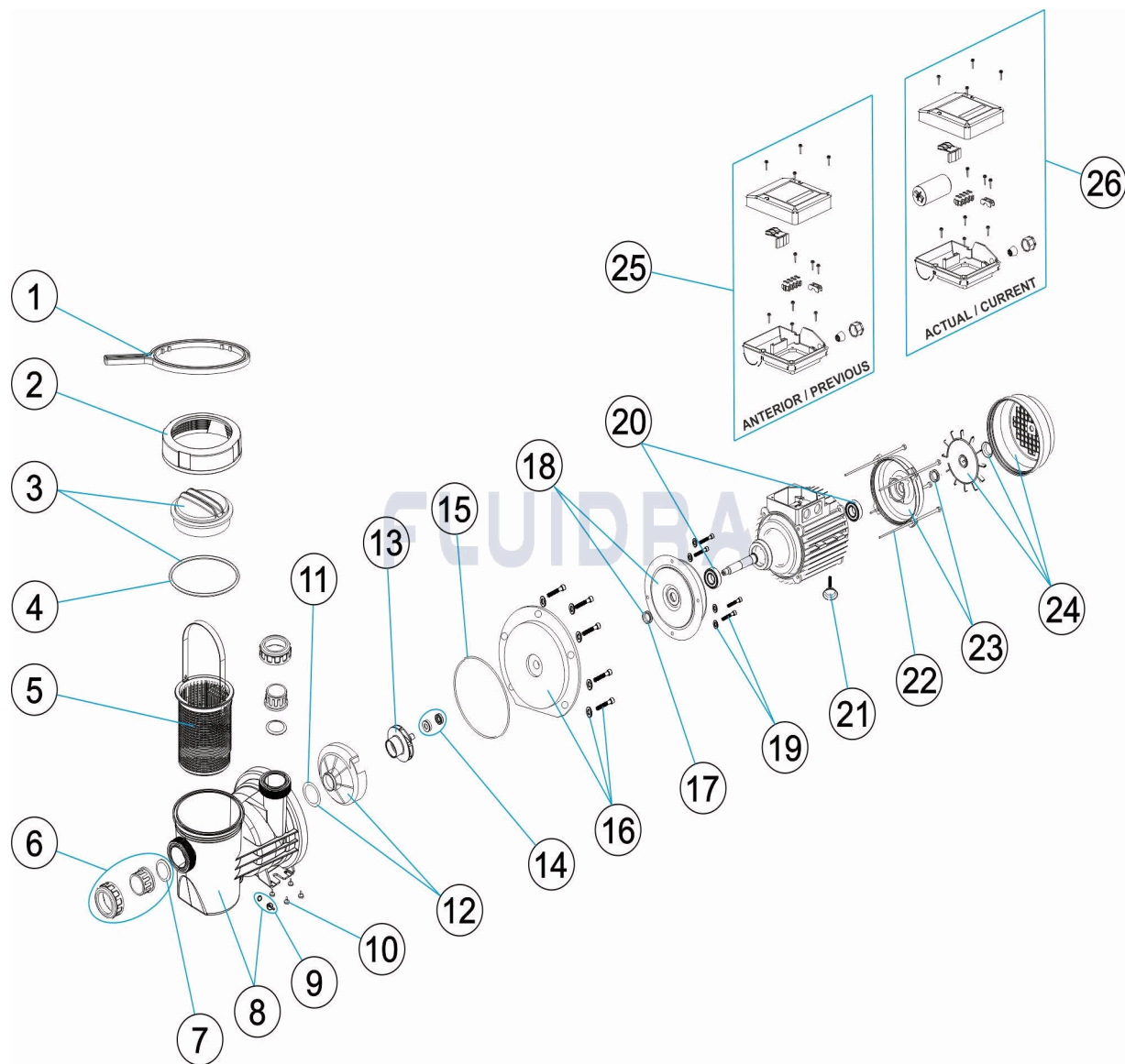
 DESCRIÇÃO: **BOMBA HGS-DS**

PORTUGUES

POS	CODIGO	DESCRIÇÃO	JANTIDADE	POS	CODIGO	DESCRIÇÃO	JANTIDADE
1	CE04130103	CHAVE PORCA FILTRO		13	* CE05012017	RODÍZIO 1 CV II	
2	CE05012401	PORCA TAMPA PRÉ-FILTRO		13	* CE05012018	RODÍZIO 1 1/2 CV II	
3	CE05012054	TAMPA PRÉ-FILTRO COM JUNTA		14	CE05012028	JUNTA MECÂNICA	
4	CE05010178	JUNTA TÓRICA D 151,7X6,99		15	CE05012029	JUNTA PLANA 193X5X11,5	
5	CE05012004	CESTO PRÉ-FILTRO		16	* CE05012030	FLANGE SUPORTE MOTOR C.71	
6	CE05012005	ACESSÓRIOS DE UNIÃO D 50		16	* CE05012031	FLANGE SUPORTE MOTOR C.80	
6	CE05012006	ACESSÓRIOS DE UNIÃO D 1 1/2"		17	* CE05010158	V-RINGS 0,5 HP - 1 HP	
6	CE05012007	ACESSÓRIOS DE UNIÃO D 63		17	* CE05010159	V-RINGS 1,5 HP - 3 HP	
6	CE05012008	ACESSÓRIOS DE UNIÃO D 2"		18	* CE05012032	BRIDA MEC. C.71 C/CAIXA D.35	
7	CE05010773	JUNTA DE UNIÃO		18	* CE05012033	BRIDA MEC. C.80 C/CAIXA D.47	
8	CE05012055	CORPO BOMBA		19	* CE05012035	PARAFUSOS FIXAÇÃO FLANGE C.71	
9	CE04121107	TAMPÃO 1/4" VÁLVULA		19	* CE05012036	PARAFUSOS FIXAÇÃO FLANGE C.80	
10	CE05012012	SILENT-BLOCK		20	* CE05010135	ROLAMENTO MOTOR < 1 HP	

* VEJA A FICHA DE OBSERVAÇÕES

CODIGO **HGS101C-DS, HGS151C-DS**

DESCRIÇÃO: **BOMBA HGS-DS**

11	CE05012013	JUNTA TÓRICA 47,63X3,53	20	* CE05012038	ROLAMENTO DIANTEIRO & TRASEIRO
12	CE05012014	DIFUSOR	21	* CE05012040	PÉ MOTOR M6X53 C.71
21	* CE05012041	PÉ MOTOR M6X45 C.80	24	* CE05010148	CONJUNTO VENTILLADOR-TAMPA 1,5 - 2 - 3
22	* CE05010144	VARETAS MOTOR 0,75 - 1 HP	25	* CE05012047	CJTO. CAIXA TERMINAIS (MOTOR II) C.71
22	* CE05010145	VARETAS MOTOR 1,5 - 3 HP III	25	* CE05012048	CJTO. CAIXA TERMINAIS (MOTOR II) C.80
23	* CE05012043	TAMPA MOTOR MEC. C.71 C/RANHURA D3	26	* CE05010890	CJTO. CONDENSADOR 12/20 MF
23	* CE05012044	TAMPA MOTOR MEC. C.80 C/RANHURA D4	26	* CE05010891	CJTO. CONDENSADOR 16/25 MF
24	* CE05010147	CONJUNTO VENTILLADOR-TAMPA 0,75 - 1			

CODIGO **HGS101C-DS, HGS151C-DS**DESCRIÇÃO: **BOMBA HGS-DS****OBSERVAÇÕES**

POS	CODIGO	OBSERVAÇÕES
13	*CE05012017	PARA: HGS101C-DS
13	*CE05012018	PARA: HGS151C-DS
16	*CE05012030	PARA: HGS101C-DS
16	*CE05012031	PARA: HGS151C-DS
17	*CE05010158	PARA: HGS101C-DS
17	*CE05010159	PARA: HGS151C-DS
18	*CE05012032	PARA: HGS101C-DS
18	*CE05012033	PARA: HGS151C-DS
19	*CE05012035	PARA: HGS101C-DS
19	*CE05012036	PARA: HGS151C-DS
20	*CE05010135	PARA: HGS101C-DS
20	*CE05012038	PARA: HGS151C-DS
21	*CE05012040	PARA: HGS101C-DS
21	*CE05012041	PARA: HGS151C-DS
22	*CE05010144	PARA: HGS101C-DS
22	*CE05010145	PARA: HGS151C-DS
23	*CE05012043	PARA: HGS101C-DS
23	*CE05012044	PARA: HGS151C-DS
24	*CE05010147	PARA: HGS101C-DS
24	*CE05010148	PARA: HGS151C-DS
25	*CE05012047	PARA: HGS101C-DS
25	*CE05012048	PARA: HGS151C-DS
26	*CE05010890	PARA: HGS101C-DS
26	*CE05010891	PARA: HGS151C-DS